

Setting Up Your iPad Mini

Your iPad Mini should be plugged in and ready to setup.

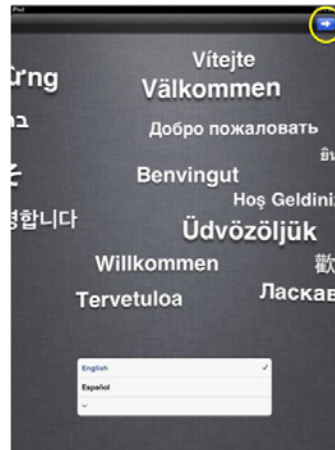

1. Slide to unlock.



2. Choose "English" and press arrow icon in top right corner.

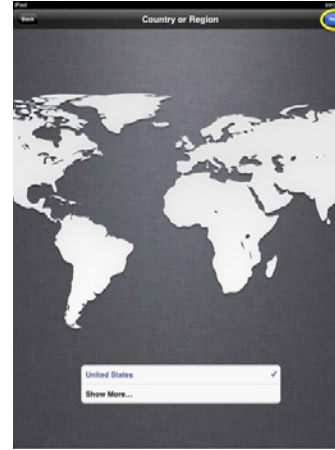

3. Choose "United States" and press "Next" in top right corner.

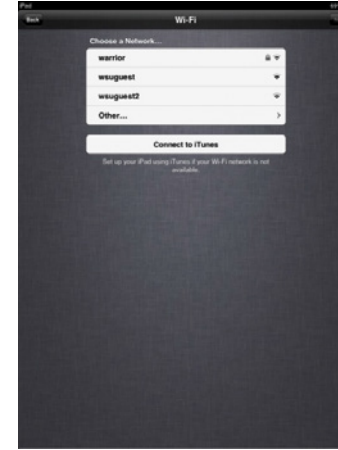

4. Choose "Warrior".

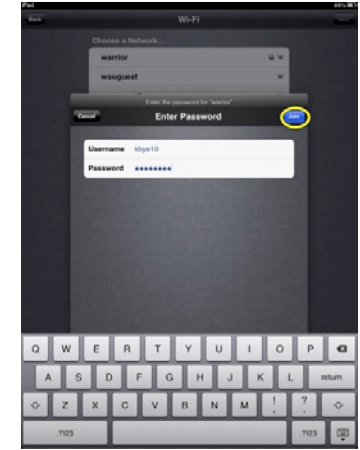

5. Log in with your WSU username and password and press "Join" in top right corner.

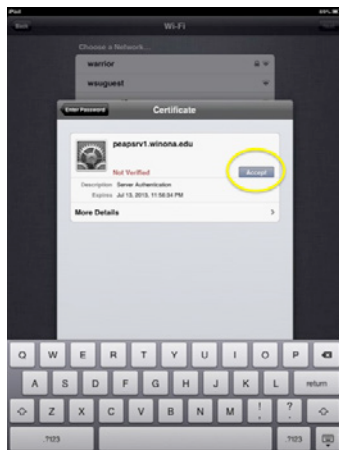

6. Select "Accept" for certificate. This may take a few minutes.

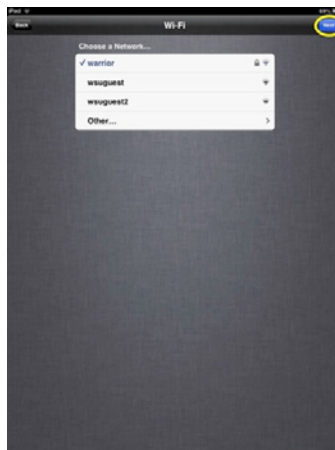

7. Select "Next" in top right corner when done loading.

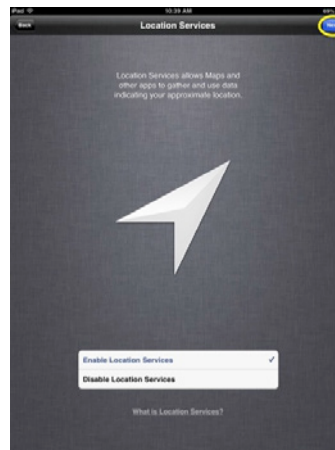

8. Select "Enable Location Services." Press "Next" in top right corner.



9. Select "Set Up as New iPad." Tap on "Next" in top right corner.

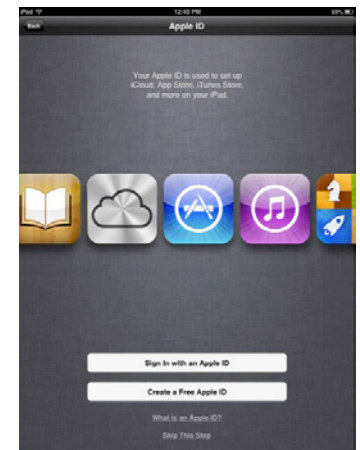

10. If you have an Apple ID or iTunes account choose "Sign in with an Apple ID" and skip to step 18. If you do not have an Apple ID choose "Create a Free Apple ID" on the bottom of the screen.

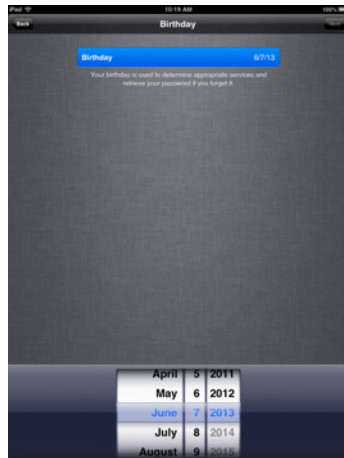

11. Select your birthdate with the rollers.

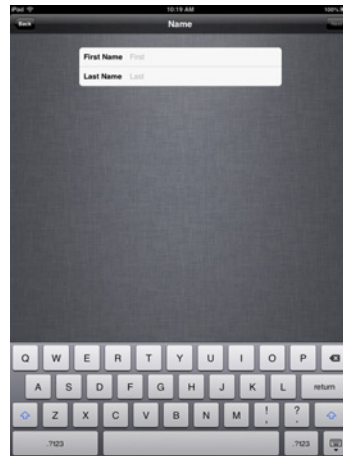

12. Enter your first and last name.

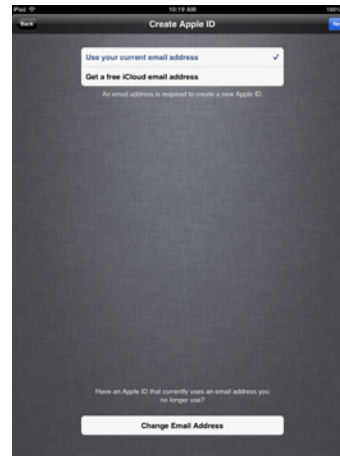

13. Choose to use your current email address.

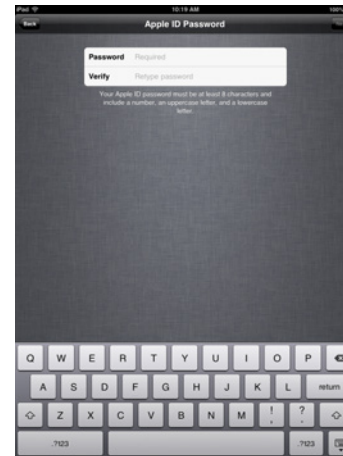

14. Enter a password and verify it.

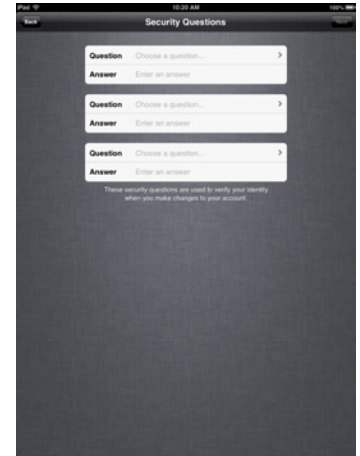

15. Select each of your Security Questions and type in an answer to them.

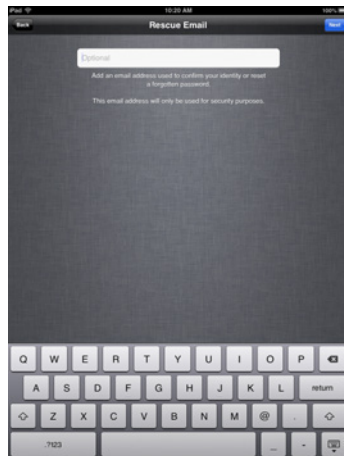

16. Press Next to skip this step.

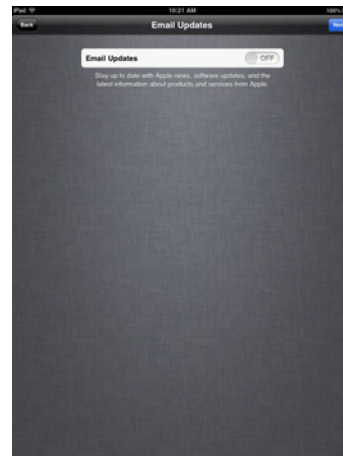

17. Turn email updates off and press next.

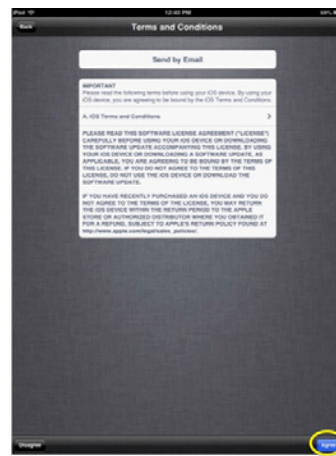

18. Read Apple's "Terms and Conditions" and tap "Agree" In bottom right corner when finished. You will need to confirm that you agree.

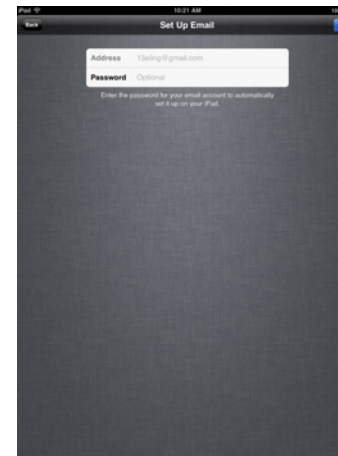

19. Press "Next" to skip this step. A pop-up will appear, confirm that you want to skip this step.

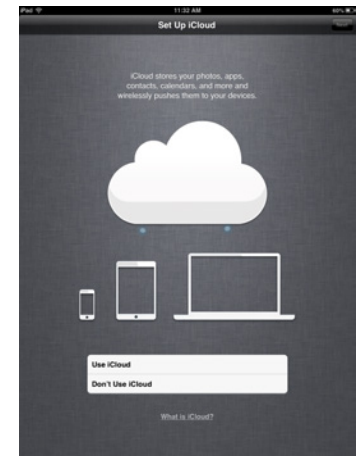

20. Select "Use iCloud" and tap on "Next" in the top right corner.

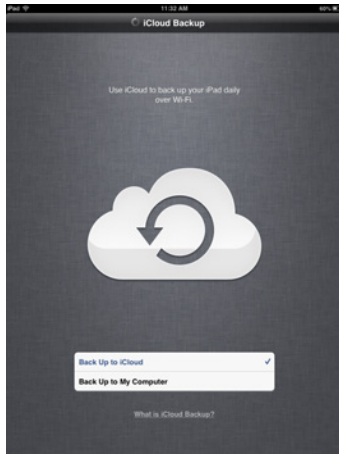

21. Select “Back Up to iCloud” and tap on “Next” in the top right corner.

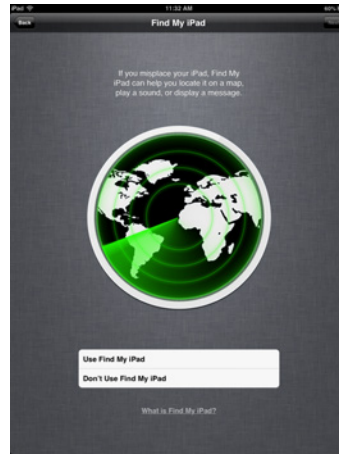

22. Select “Use Find My iPad” and tap on “Next” in the top right corner.

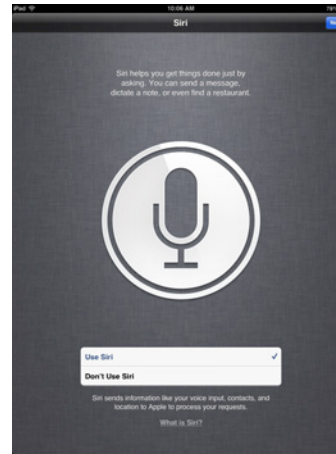

23. Select “Use Siri” and click on Next in top right corner..

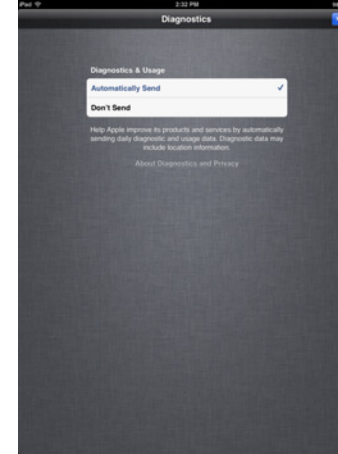

24. Choose “Don't Send” for Diagnostics and Usage then click on “Next” in top right corner.

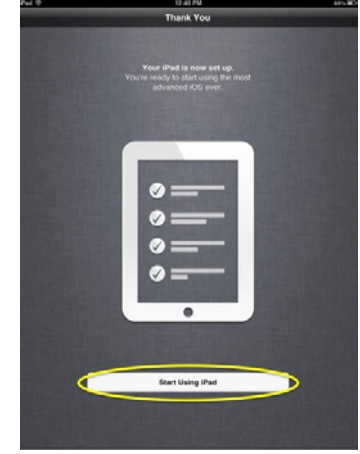

25. Choose “Start Using iPad.”



26. Open Safari.

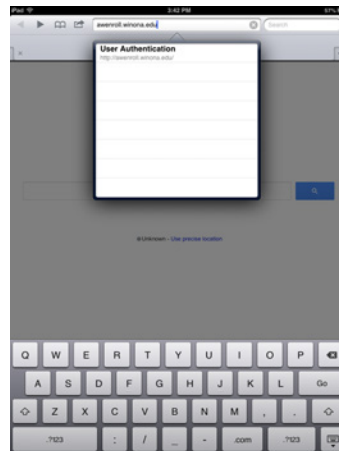

27. Type “awenroll.winona.edu” in the address bar.

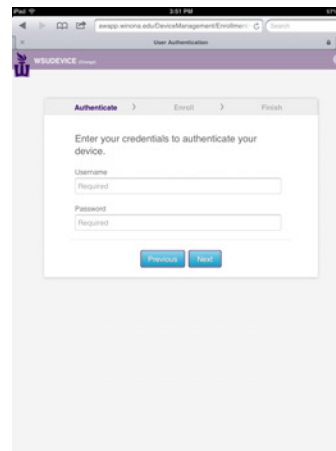

28. Enter your WSU username and password.



29. Select “Install” to install profile. Select “Install Now” on pop-up.



30. A warning will appear. After reading select “Install.”



31. After the profile is finished installing click on “Done” and wait to be prompted to insert your password.

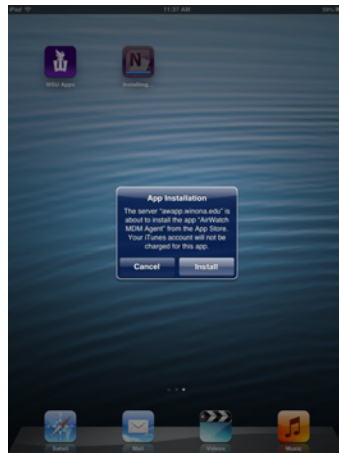

32. A window asking to install “MDM Agent” will eventually appear. Tap on “Install” and insert your Apple password.



33. This window will prompt you to download “OneNote.” Tap on “Install.”

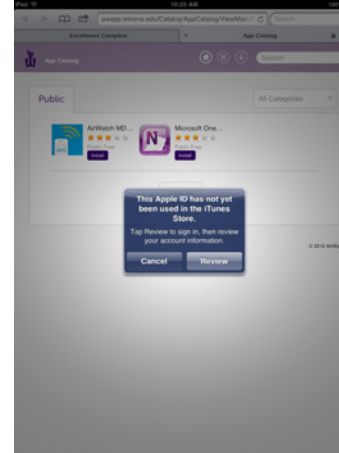

34. If you just created your Apple ID a pop-up will appear prompting you to review your account information. If you had an Apple ID already skip to step 38.

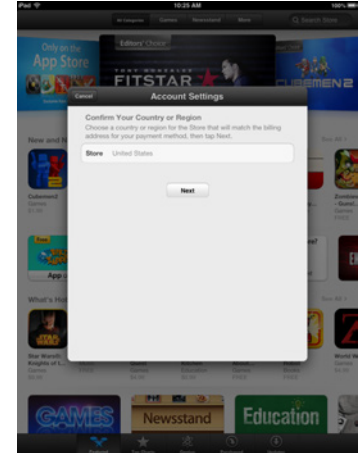

35. Make sure United States is selected and press “Next.”

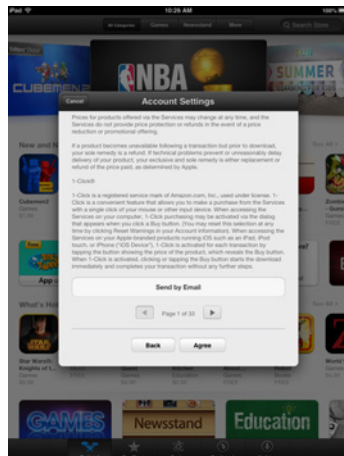

36. Read the terms and conditions then scroll to the bottom and choose Agree.

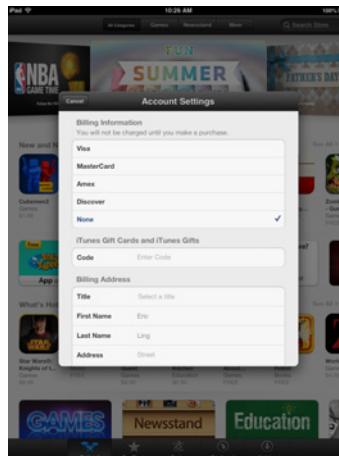

37. Enter in your address information and press next at the bottom.

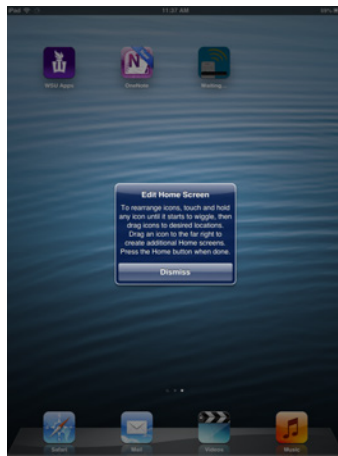

38. Read the “Edit Home Screen” window then select on “Dismiss.”

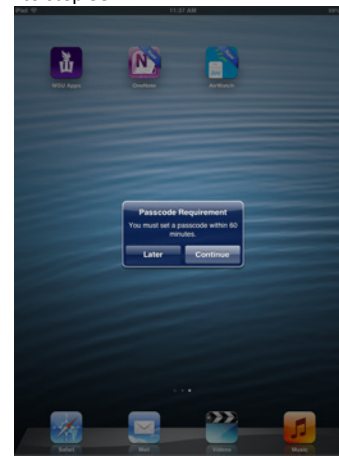

39. You will now have to create a passcode for your iPad. Tap on “Continue.”



40. Create any 4 digit passcode that you will remember and verify the code when it asks you to.

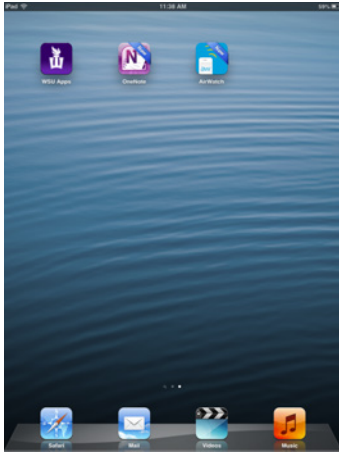

41. If you swipe to the right you should see 3 new apps. If you do not ask a technician.

When you have finished setting up your iPad please shut it down.

- Press the Home button on the the iPad
 - Located on bottom in the middle of the iPad
- Hold down the “Sleep/Wake” Button
- Slide red slider to the right

